

**GLADDING**  
**South Bend Tackle Co., Inc.**  
 Division of GLADDING Corporation

**20**

3-000-020

**CASTING REEL**

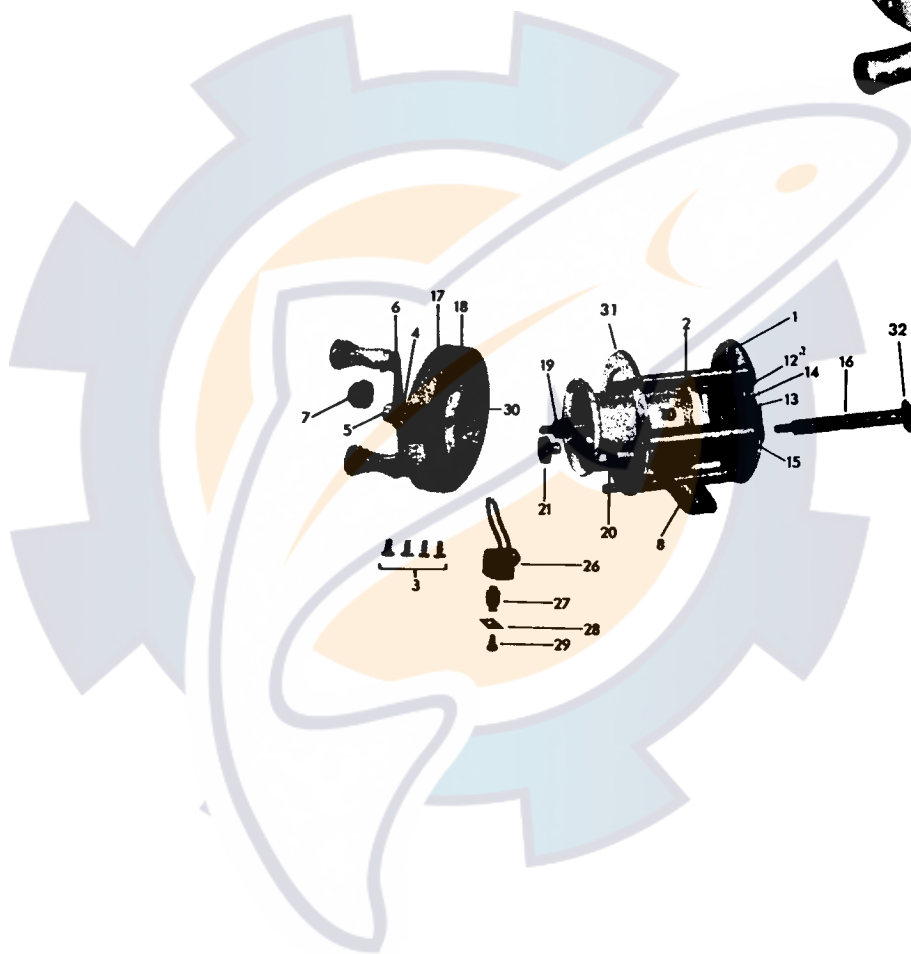
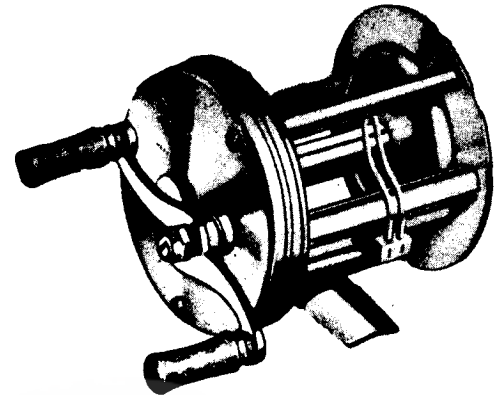

Detail No.	Part Name	Part No.	Price	Detail No.	Part Name	Part No.	Price
1	Frame Assembly Complete . . . . .	RA-36	3.50	17	Drive Gear Without Stem . . . . .	R-16	.30
2	Top Pillar . . . . .	R-33	.25	18	Head Cap Assembly . . . . .	RA-28	1.25
3	Pillar Screw . . . . .	R-18	.10	19	Spool Pinion . . . . .	RA-17	.35
4	Gear Stem Bearing . . . . .	RA-27	.20	21	Carriage Screw Pinion . . . . .	R-8	.15
5	Crank Nut . . . . .	R-11	.25	22	Click Button . . . . .	R-37	.15
6	Crank Assembly . . . . .	RA-12	1.00	23	Tail Spool Cap . . . . .	R-20	.55
7	Head Spool Cap . . . . .	RE-20	.35	24	Click Spring Rivet . . . . .	C-43	.10
8	Rod Clip . . . . .	RA-31	.70	26	Line Carriage . . . . .	R-3	.50
9	Side Pillar . . . . .	R-32	.20	27	Carriage Pawl . . . . .	R-4	.20
10	Spool Assembly . . . . .	R-19C	1.25	28	Carriage Pawl Retainer . . . . .	R-5	.10
11	Click Button Stem . . . . .	RA-26	.10	29	Carriage Pawl Retainer Screw . . . . .	R-6	.10
12	Click Pawl . . . . .	R-9	.10				
13	Click Spring . . . . .	R-10	.15				
14	Spool Bushing Head . . . . .	R-35B	.15				
14T	Spool Bushing Tail . . . . .	R-35A	.15				
15	Line Protector . . . . .	RA-21	.25				
16	Line Carriage Screw . . . . .	RQ-7	.50				